

Laboratory Connector

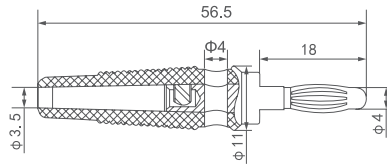

Item	ZBP-041
Insulator	PVC
Body	Brass / Nickel plated
Spring	Beryllium copper
Rated voltage / current	30Vac-60Vdc / Max.24A

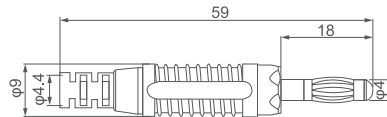

Item	ZBP-042
Insulator	PA
Body	Brass / Gold plated
Spring	Beryllium copper
Rated voltage / current	30Vac-60Vdc / Max.24A

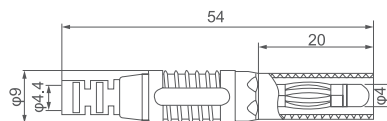

Item	ZBP-043
Insulator	PA
Body	Brass / Nickel plated
Spring	Beryllium copper
Rated voltage / current	CAT II 1000V / Max.32A

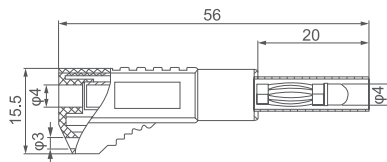

Item	ZBP-044
Insulator	PA
Body	Brass / Nickel or gold plated
Spring	Beryllium copper
Rated voltage / current	CAT II 600V / Max.32A

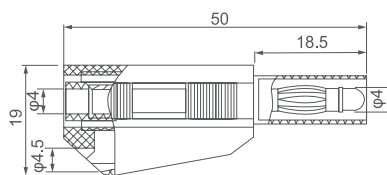

Item	ZBP-045
Insulator	PA
Body	Brass / Nickel or gold plated
Spring	Beryllium copper
Rated voltage / current	CAT II 600V / Max.32A

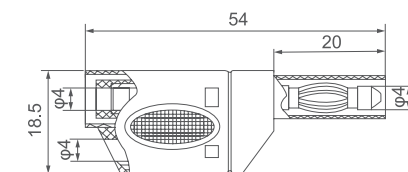

Item	ZBP-046
Insulator	PA
Body	Brass / Nickel or gold plated
Spring	Beryllium copper
Rated voltage / current	CAT II 1000V / Max.32A



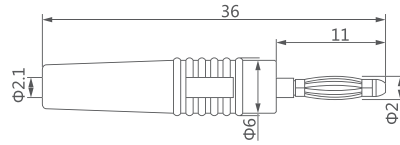

Item	ZBP-021
Insulator	PVC
Body	Brass / Gold plated
Spring	Beryllium copper
Rated voltage / current	30Vac-60Vdc / Max.10A

1 2 3 4 5

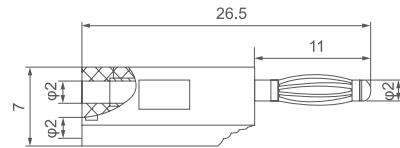

Item	ZBP-022
Insulator	PE
Body	Brass / Gold plated
Spring	Beryllium copper
Rated voltage / current	30Vac-60Vdc / Max.10A

1 2 3 4 5

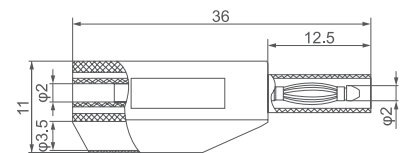

Item	ZBP-023
Insulator	PA
Body	Brass / Nickel plated
Spring	Beryllium copper
Rated voltage / current	CAT II 600V / Max.10A

1 2 3 4 5

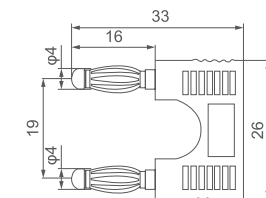
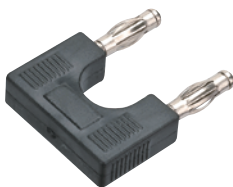

Item	ZSCP-011
Insulator	ABS
Body	Brass / Nickel plated
Spring	Beryllium copper
Rated voltage / current	30Vac-60Vdc / Max.32A

1 2 7

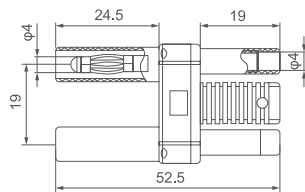

Item	ZSCP-012
Insulator	PA
Body	Brass / Nickel plated
Spring	Beryllium copper
Rated voltage / current	CAT II 1000V / Max.32A

2

Laboratory Connector

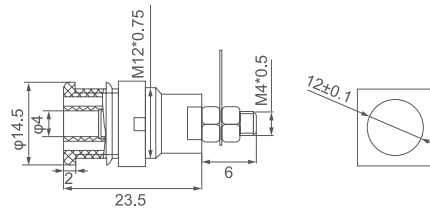

Item	ZBS-141S
Insulator	PA
Body	Brass / Nickel plated
Rated voltage / current	CAT II 1000V / Max.32A

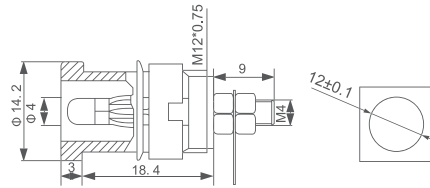

Item	ZBS-141G
Insulator	PA
Body	Brass / Nickel plated
Rated voltage / current	CAT II 1000V / Max.32A

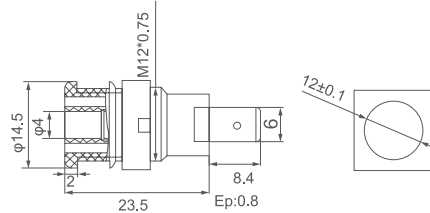

Item	ZBS-141F
Insulator	PA
Body	Brass/Nickel plated
Rated voltage / current	CAT II 1000V / Max.32A

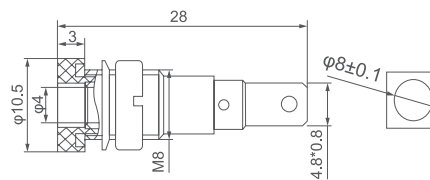

Item	ZBS-142
Insulator	PA
Body	Brass / Nickel plated
Rated voltage / current	30Vac-60Vdc / Max.24A

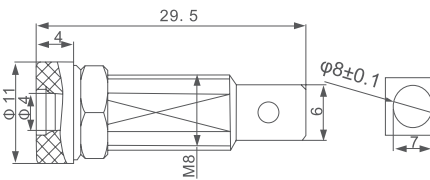

Item	ZBS-143
Insulator	PA
Body	Brass / Nickel plated
Rated voltage / current	30Vac-60Vdc / Max.24A

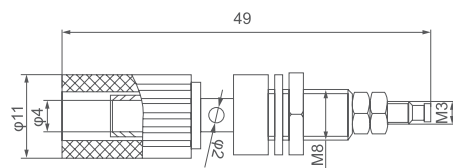

Item	ZBS-144
Insulator	ABS
Surface	Nickel plated
Rated voltage / current	30Vac-60Vdc / Max.19A



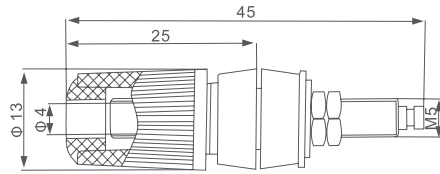

Item	ZBS-145
Insulator	ABS
Body	Brass / Nickel plated
Rated voltage / current	30Vac-60Vdc / Max.24A

1 2 3 4 5

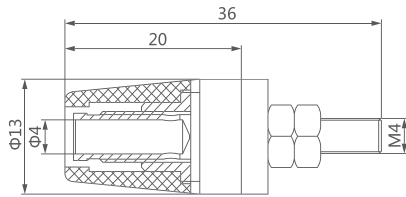

Item	ZBS-147
Insulator	ABS
Body	Brass / Nickel plated
Rated voltage / current	30Vac-60Vdc / Max.24A

1 2 3 4 5

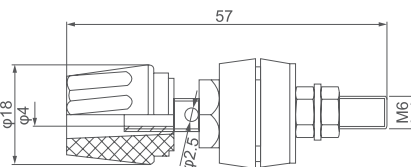

Item	ZBS-146
Insulator	ABS
Body	Brass / Nickel plated
Rated voltage/current	30Vac-60Vdc / Max.50A

1 2 3 4 5

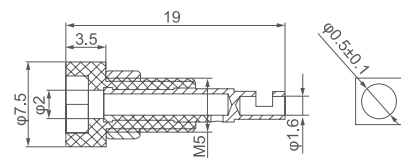

Item	ZBS-121
Insulator	PA
Body	Brass / Nickel or gold plated
Rated voltage / current	30Vac-60Vdc / Max.10A

1 2 3 4 5

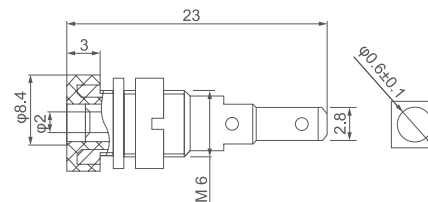

Item	ZBS-122
Insulator	PA
Body	Brass/Nickel plated
Rated voltage / current	30Vac-60Vdc / Max.10A

1 2 3 4 5

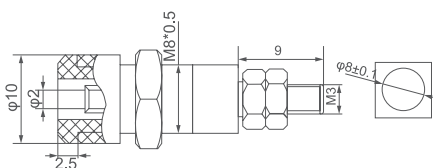

Item	ZBS-123S
Insulator	PA
Body	Brass/Nickel or Gold plated
Rated voltage / current	CAT II 600V / Max.10A

1 2 3 4 5

Laboratory Connector



Item	ZTL-241P	ZTL-241S
Wire Insulation	PVC	Silicon
Rated Voltage	30Vac-60Vdc	
Rated Current	0.75mm ² 15A / 1.0mm ² 19A	
Length	25cm 50cm 100cm	

Test lead with the 4mm nickel plated plug on both ends.



Item	ZTL-242P	ZTL-242S
Wire Insulation	PVC	Silicon
Rated Voltage	1000V	
Rated Current	0.75mm ² 15A / 1.0mm ² 19A / 2.5 mm ² 32A	
Length	25cm 50cm 100cm	

Safety test lead with the insulated 4mm straight plug on both ends. Nickel plated plugs with the protective cap. Assembled Item.



Item	ZTL-243P	ZTL-243S
Wire Insulation	PVC	Silicon
Rated Voltage	600V	
Rated Current	1.0mm ² 19A / 2.5 mm ² 32A	
Length	25cm 50cm 100cm	

Safety test lead with the 4mm retractable plug on both ends. Nickel or gold plated plugs with the retractable tube and red cap.



Item	ZTL-244J	ZTL-244S
Wire Insulation	PVC	Silicon
Rated Voltage	600V	
Rated Current	1.0mm ² 19A / 2.5 mm ² 32A	
Length	25cm 50cm 100cm	

Safety test lead with the insulated 4mm stackable plug on both ends. Nickel plated plugs with the red cap.





Item	ZTL-245P	ZTL-245S
Wire Insulation	PVC	Silicon
Rated Voltage	600V	
Rated Current	1.0mm ² 19A / 2.5 mm ² 32A	
Length	25cm 50cm 100cm	

Safety test lead with the insulated 4mm stackable plug on both ends. Nickel plated plugs with the red cap.



Item	ZTL-221P	ZTL-221S
Wire Insulation	PVC	Silicon
Rated Voltage	30Vac-60Vdc	
Rated Current	Max.10A 0.50mm ²	
Length	25cm 50cm 100cm	

Test lead with the 2mm gold plated plug on both ends.

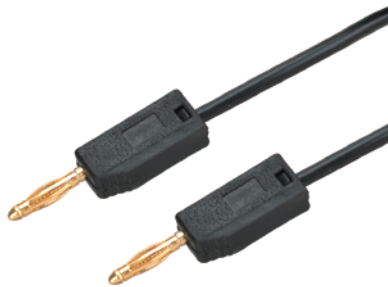

Item	ZTL-222P	ZTL-222S
Wire Insulation	PVC	Silicon
Rated Voltage	30Vac-60Vdc	
Rated Current	Max.10A 0.50mm ²	
Length	25cm 50cm 100cm	

Test lead with the 2mm stackable gold plated plug on both ends.



Laboratory Connector

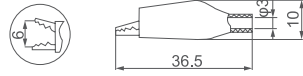

Item	ZAC-070
Insulator	PVC
Body	Steel / Nickel plated
1 2 3 4 5 6	

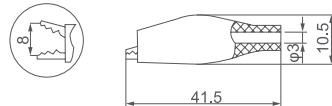

Item	ZAC-071
Insulator	PVC
Body	Steel / Nickel plated
1 2 3 4 5 6	

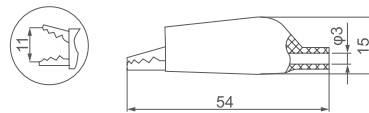

Item	ZAC-072
Insulator	PVC
Body	Steel / Nickel plated
1 2 3 4 5 6	

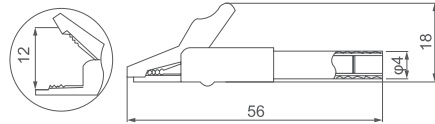

Item	ZAC-073
Insulator	PA
Body	Brass / Nickel plated
Rated voltage/current	CAT II 300V / Max.15A
1 2 3 4 5	

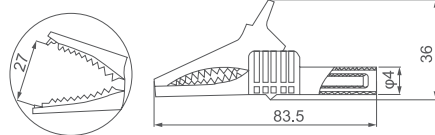

Item	ZAC-074
Insulator	PA
Surface	Nickel plated
Rated voltage/current	CAT II 1000V / Max.32A
1 2 3 4 5	

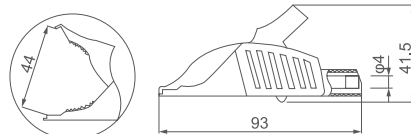

Item	ZAC-075
Insulator	PA
Body	Brass / Nickel plated
Rated voltage/current	CAT II 1000V / Max.32A
1 2 3 4 5	

